



nhow



ROTTERDAM



BERLIN



MILAN

ELEVATE YOUR STAY

Offbeat, lively, dynamic, that's nhow! Looking to get more out of your stay? Elevate your stay in one of our hotels and experience the best of what the city has to offer. Surround yourself with the latest local design, lifestyle & culture, yet sleep in a luxury hotel with worldwide appeal.

NHOW ROTTERDAM

ART, ARCHITECTURE & ONE HELL OF A VIEW

After nhow Berlin and nhow Milan you can elevate your stay in nhow Rotterdam.

The city of Rotterdam is set apart by its fierce commitment to moving forward, to new ideas and fresh perspectives. It is constantly changing and redefining what is 'now'. This is reflected by its inhabitants, its art, its creative industry and its architecture. And you are invited to become part of it!

Surround yourself with the freshest that Rotterdam's urban culture has to offer. And do so in four-star luxury.





ELEVATED BUSINESS

nhow is the meeting place for forward thinkers. It's open for anyone that wants to meet, sleep, eat and get inspired in the first hotel by renowned architect OMA/Rem Koolhaas.

Host an event unlike anything you've ever organized in the unique, creative and fully adaptive environment of nhow Rotterdam. Bathed in all natural light thanks to Rem Koolhaas' open architecture, all of our conference spaces have an awe-inspiring view, state-of-the-art technology, local urban art and top-notch catering. In short: this is something else!



THIS IS WHY YOU BOOK NHOW:

(and not just another boring hotel)

- o 278 rooms
- o 11 flexible meeting rooms
- o Art, Architecture & design
- o First OMA/Rem Koolhaas hotel
- o Breathtaking views
- o State of the art facilities
- o Free WiFi everywhere
- o Covered parking (600+ places)
- o Inspiration on the spot



MEETINGS & EVENTS

We can be pretty simple about our service: we'll do anything* to make your event a success! So whatever it is that you need we'll do our very best to make it happen. Completely rebuild an area? Book a DJ? Special banqueting? Extra suites? Just let us know.

*as long as it's not too illegal.

We like to think big. Together with partner locations like the Cruise Terminal, Lantaren Venster, Floating Pavilion, Las Palmas, Nederlands Fotomuseum and Luxor, all within walking distance, we make events and parties for up to 2500 people possible!

	Height (m)	Width (m)	Length (m)	Area (m ²)	Boardroom	U-Table	Carré	Theatre	Cabaret	Dinner	Cocktail
nhow 1	3,4	6	7,8	46,8	12	16	20	24	-	12	40
nhow 2	3,4	6,5	6,8	50,7	12	16	20	32	32	12	40
nhow 3	3,4	8	15,7	126	30	40	46	90	66	70	150
nhow 4	3,4	9,4	15,7	148	30	40	46	112	66	100	150
nhow 5	3,4	9,4	15,7	148	30	40	42	100	68	80	150
nhow 6	3,4	8	15,7	126	30	35	40	100	68	80	150
nhow 7	3,4	6,7	10	67	18	23	26	40	24	50	75
nhow 8	3,4	6	11	66	16	-	-	-	-	16	-
nhow 2+3+4 / 5+6+7	3,4	24,1	10-15,7	340			80	235	120		350
LOFT 1	3,4	7,9	7,8	61	14	-	-	25	20	14	40
LOFT 2	3,4	18,7	15,4	285	-	-	-	100	60	140	200
LOFT 3	3,4	16,9	15,4	258	-	-	-	80	40	120	200
LOFT 2+3	3,4	35,6	15,4	543	-	-	-	180	100	250	400

11 MEETING & EVENT SPACES

OMA | Rem Koolhaas design

FLOOR TO CEILING WINDOWS

offering views of the Erasmus Bridge, Maas river and skyline.

FLEXIBLE SPACES

with possibilities to divide and combine spaces approx.
66-543m² | 3.40 meter high ceilings.

HIGH QUALITY AUDIO AND VIDEO FACILITIES

making it an event to remember.

THE LOFT

The Loft is our newly added state-of-the-art Meetings & Events venue: 700m² of fully customisable space, with an unbeatable view and raw industrial architecture by OMA/Rem Koolhaas. We like to give our guests a unique experience where they can create anything they want.

Or as we like to say: **THINK LIMITLESS**

We like to think big. And even though we have several conference rooms that are amazing, we are pretty sure that The Loft will add an extra 'wow' to your meetings & events. The best thing is, you can not only host meetings but also throw an after drink or party as well. And if you feel like hosting an exhibition, fashion show, wedding party or event, we will make it happen! The Loft is designed to inspire in a spectacular way with of course the best view in town.

- o 700m²
- o Unique open space
- o Designed by OMA/Rem Koolhaas
- o Up to 500 guests capacity
- o Unbeatable view
- o Floor-to-ceiling windows
- o Custom-built mobile bar
- o Movable separation walls
- o Customisable lighting grid
- o Top-notch F&B facilities
- o Integrated audio / video facilities
- o Unlimited customizability

	Height (m)	Width (m)	Length (m)	Area (m ²)	Board-room	U-Table	Carré	Theatre	Cabaret	Dinner	Cocktail
LOFT 1	3,4	7,9	7,8	61	14	-	-	25	20	14	40
LOFT 2	3,4	18,7	15,4	285	-	-	-	100	60	140	200
LOFT 3	3,4	16,9	15,4	258	-	-	-	80	40	120	200
LOFT 2+3	3,4	35,6	15,4	543	-	-	-	180	100	250	400



OUR ROOMS

Have you ever had a stay in a hotel that was simply unforgettable? We're sure that it wasn't just the comfy bed, nice shower or free wifi in your room that made it unforgettable. That's why all of our rooms don't just offer you everything to make your stay as comfortable as possible, but also the greatest view of Rotterdam that you'll find anywhere in the city. You'll be as well-rested as you'll be inspired.

- o **278 rooms**
 - 120 nhow Rooms
 - 89 nhow Premium Room with Sunrise View
 - 63 nhow Premium Room with Skyline View
 - 6 nhow Suite by Rem Koolhaas
- o **Stunning views**
- o **Special nhow care amenities**
- o **Smart TV with mobile device connection**
- o **Air conditioned**
- o **Minibar and room safe**
- o **Room service**
- o **Organic breakfast buffet available**
- o **Covered parking**
- o **Superfast free WiFi in the entire hotel**



ROOM TYPES

	NHOW ROOM	NHOW PREMIUM ROOM WITH SUNRISE VIEW	NHOW PREMIUM ROOM WITH SKYLINE VIEW	NHOW SUITE BY REM KOOLHAAS
Queen size bed or twin beds	YES	YES	YES	YES
Lazy Bastard relax chair by Montis	YES	YES	YES	YES
Free fitness	YES	YES	YES	YES
Free wifi	YES	YES	YES	YES
Free Nespresso & tea	YES	YES	YES	YES
Bathroom with shower and/or bath	YES	YES	YES	YES
Interactive TV (controlled by smartphone)	YES	YES	YES	YES
Personal safe	YES	YES	YES	YES
Minibar	YES	YES	YES	YES
South view	NO	YES	NO	NO
Skyline view	NO	NO	YES	YES
Free iron and ironing board	NO	YES	YES	YES
Living room with table with 4 seats	NO	NO	NO	YES
A two-room suite on the corner of the building	NO	NO	NO	YES
Bathrobe, slippers	NO	NO	NO	YES
A view of the entire city and port of Rotterdam	NO	NO	NO	YES



EAT & DRINK



Like any other metropolitan city, Rotterdam boasts many different cultures and cuisines, and this is represented in our F&B facilities as well. So enjoy the many flavours from around the world in our bar and kitchen, but with a distinct Rotterdam twist and one hell of a view. Locals, guests and business groups can get a boost at our own espresso bar at street level.

BAR

Best Hotel Bar 2014 of Rotterdam! Great ambiance to have a drink with your friends while enjoying the view over the skyline.

KITCHEN

Our KITCHEN is open seven days a week for a bite. Enjoy a quick burger or a culinary 6 course dinner. It's up to you!

THE LOFT

Limitless event space. Create everything, unlike anything. Let us know what your kick- ass event will be!

ESPRESSO BAR

Every day of the week our baristas make you the best coffees to stay or to go!



FACILITIES

- o Free WiFi
- o Gym with a view
- o Early business breakfast
- o Covered parking
- o Bike rental
- o Ironing service
- o Daily international newspapers
- o 24/7 roomservice

SUSTAIN- ABILITY

- o Golden Green Key Certified
- o Energy-producing elevators
- o Organic, innovative heating installation
- o Cooling system with river Maas water
- o LED lighting
- o Bathroom made of recycled glass
- o Local partners for food and beverage

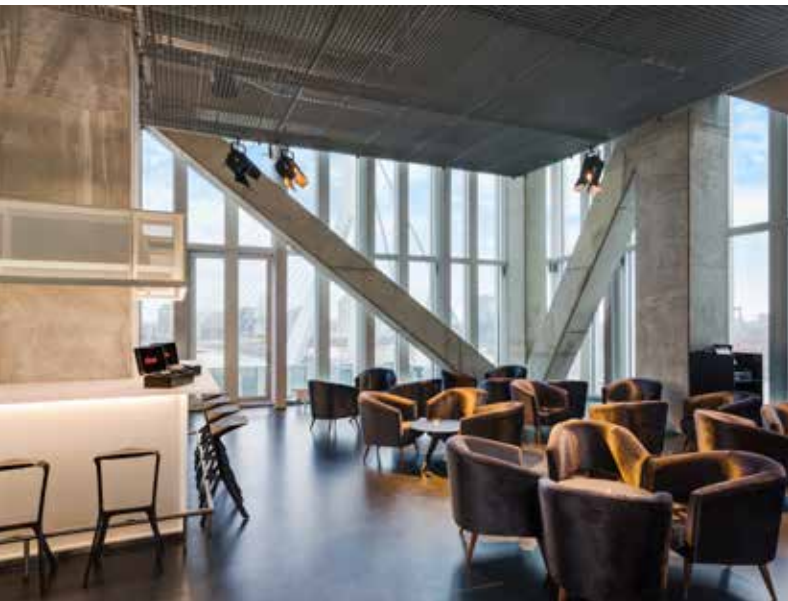

LOCATION & CONTACT

WILHELMINAPIER

Now Rotterdam is located directly at the Maas river. The locals refer to this pier as 'Manhattan at the Maas'. This trendy area surprises you with loads of restaurants, history, theatres, galleries and museums.

nhow

GETTING THERE AND AWAY

Rotterdam Central Station
3.6 km / 10 min drive | 4 stops metro D/E line

Rotterdam The Hague Airport
10 km / 16 min drive
metro E line shuttle service available

The Hague Central Station
28 km / 30 min drive | 30 min metro E line

Ahoy Rotterdam
3.9 km / 10 min drive | 3 stops metro D/E line

Schiphol Amsterdam Airport
60 km / 45 min drive | 21 min IC high speed train (Intercity direct)

PARKING

Q-Park in De Rotterdam - €20/day

nhow ROTTERDAM

Wilhelminapier | Kop van Zuid

Wilhelminakade 137
3072 AP Rotterdam
Netherlands
+31 10 2067600
rotterdam@nhow-hotels.com

NHOW-HOTELS.COM | THISISNHOW.COM



